

## Introduction

Thank you for purchasing Vestax CLS-1. This product (CLS-1) is a rubber spacer to decrease the "cut lag" that exists on each fader. Faster operation with the cross fader (sound point is closer) is possible by attaching the CLS-1.

### NOTE 1

CLS-1 is an option part to decrease cut lag. If it is not set to the correct position, there will be a possibility of the sound not cutting. Please make sure it is set to the correct position.

### NOTE 2

The cut lag on each fader is slightly different. If there are any sound leaks or problems with the cut lag even if it is set correctly, please inform Vestax Service Department.

## Equivalent Models

CLS-1 can be attached to the CROSS FADER on Vestax models. It cannot be attached to models that are not listed below or to other company's models. Problems that are caused from other models are the customer's responsibility.

## Equivalent Model List

PMC-05Pro, PMC-05Pro II, PMC-06Pro, PMC-06ProA, PMC-07Pro, PMC-07ProISP, PMC-05ProQ	Attachable if printed "SFV-03N" on the fader.
PMC-05Pro III, PMC-05ProSL, PMC-007, QFO	Attachable to all faders.

## Instructions

- ① Detach the fader unit as it is shown on the mixers owners' manual.
- ② Unscrew the 2 screws on each end with a screw driver and remove the fader panel as shown in Fig.1

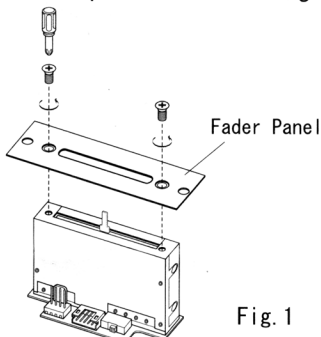

Fig. 1

- ③ Slide in CLS-1 to each side of the fader as shown in Fig.2

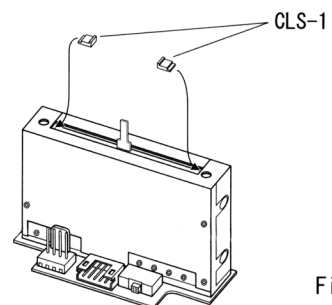
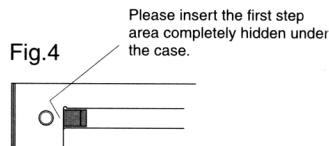
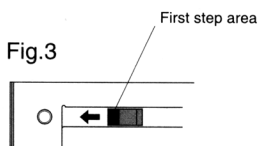

Fig. 2

- ④ When inserting CLS-1, make sure the first step of the rubber is underneath the fader case. As shown in Fig.3 and Fig.4



- ⑤ Screw on the fader panel to the fader unit.

- ⑥ Follow the instructions on the mixers owners' manual to connect the fader unit.